

NOTES:

1) CLOSED CELL EPDM SPONGE RUBBER (0.250 G/CM³)

2) 1" ST-1200 HEAT ACTIVATED TAPE (0.017 LB/FT)

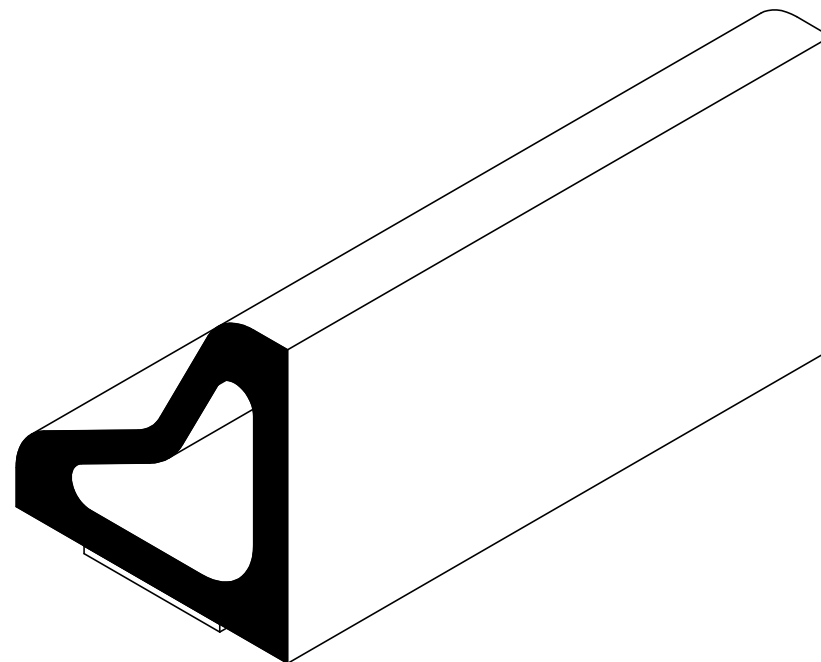
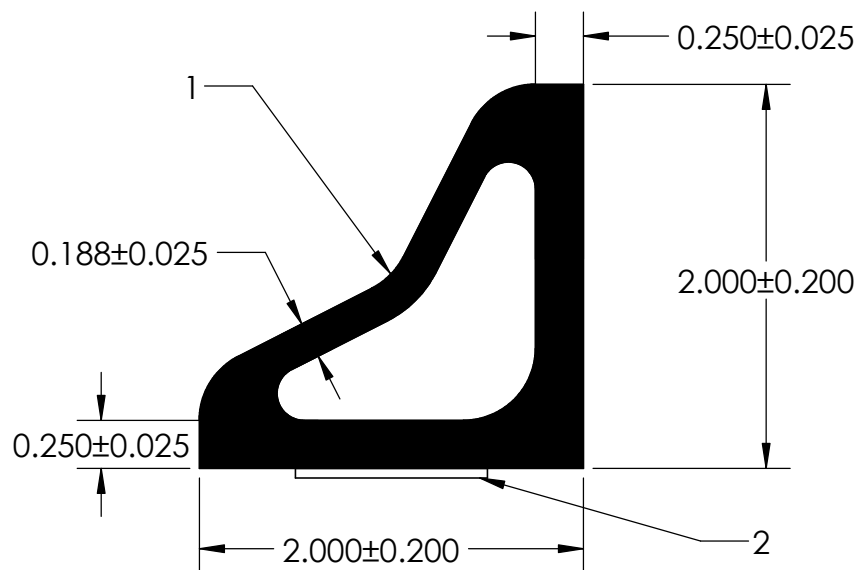

UNI-GRIP, INC.

9823 STATE ROUTE 53 N
UPPER SANDUSKY, OHIO 43351

REVISION BLOCK				PROPRIETARY AND CONFIDENTIAL:	UNLESS OTHERWISE SPECIFIED:	TITLE:				
REV.	DATE	R. By	CHANGES MADE	THE INFORMATION CONTAINED IN THIS DRAWING IS THE SOLE PROPERTY OF UNI-GRIP, INC. ANY REPRODUCTION IN PART OR AS A WHOLE WITHOUT THE WRITTEN PERMISSION OF UNI-GRIP, INC. IS PROHIBITED.	DIMENSIONS ARE IN INCHES TOLERANCES PER ARPM CLASS 3	TS-176				
A										
B					WEIGHT	0.194 LB/FT				
C					ASTM D1056	2A2	SIZE	DWG. NO.	REV	
D					DOCUMENT CONTROL NUMBER	ASTM D2000	A	UG-1-TS-1000-TP-176		
E				UG-1-EN-001-FR-(080918)	N/A	DR. BY	C. VENT	DATE	11/17/2020	SHEET 1 OF 1
P:\Engineering\Prints\Master Prints\Tape Seals\TS-176 UG-1-TS-1000-TP-176				SCALE:	1:1					