

NOTES:

- 1) CLOSED CELL EPDM SPONGE RUBBER (0.725 G/CM³)
- 2) 1/2" 3M ST-1200 HEAT ACTIVATED (0.010 LB/FT)

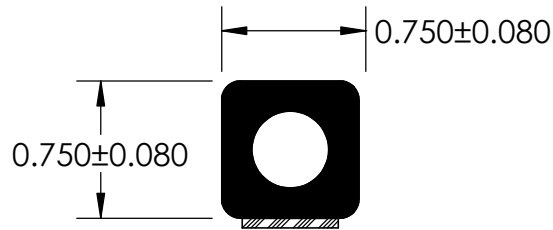
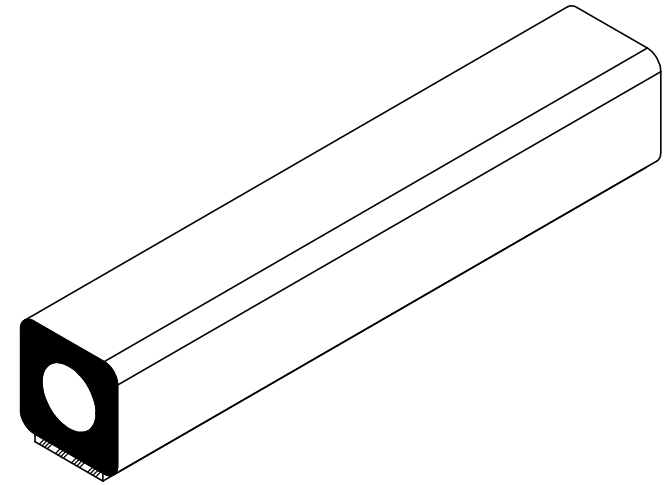

UNI-GRIP, INC.

9823 STATE ROUTE 53 N
UPPER SANDUSKY, OHIO 43351

PROPRIETARY AND CONFIDENTIAL: THE INFORMATION CONTAINED IN THIS DRAWING IS THE SOLE PROPERTY OF UNI-GRIP, INC. ANY REPRODUCTION IN PART OR AS A WHOLE WITHOUT THE WRITTEN PERMISSION OF UNI-GRIP, INC. IS PROHIBITED.	UNLESS OTHERWISE SPECIFIED: DIMENSIONS ARE IN INCHES TOLERANCES PER ARPM CLASS 3	TITLE: <p style="text-align: center;">SD-300-T</p>		
	WEIGHT <p style="text-align: center;">0.128 LB/FT</p>	SIZE <p style="text-align: center;">A</p>	DWG. NO. <p style="text-align: center;">UG-1-TS-500-TP-061</p>	REV <p style="text-align: center;">A</p>
	DOCUMENT CONTROL NUMBER UG-1-EN-001-FR-(111416)	ASTM D1056 <p style="text-align: center;">2A3</p>	DR. BY <p style="text-align: center;">C. VENT</p>	DATE <p style="text-align: center;">12/12/2017</p>
SCALE: 1:1		SHEET 1 OF 1		