

NOTES:

- 1) 70 DUROMETER EPDM DENSE RUBBER (1.200 G/CM³)
- 2) CLOSED CELL EPDM SPONGE RUBBER (0.700 /CM³)
- 3) SLIP COAT

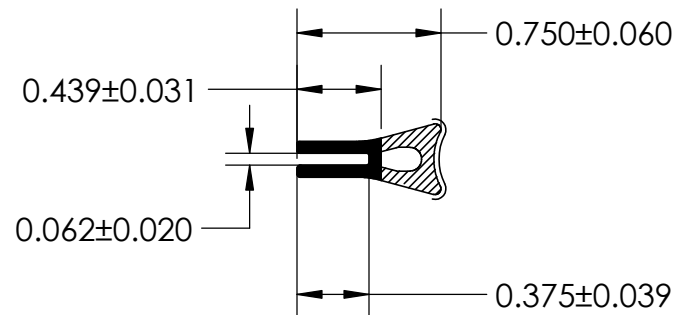
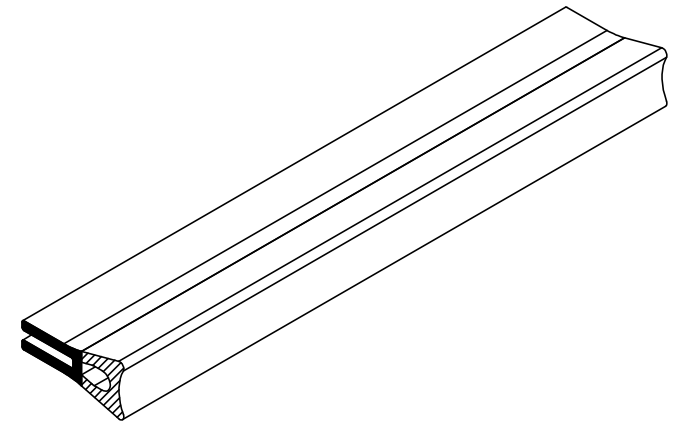

UNI-GRIP, INC.

9823 STATE ROUTE 53 N
UPPER SANDUSKY, OHIO 43351

REVISION BLOCK				PROPRIETARY AND CONFIDENTIAL:	UNLESS OTHERWISE SPECIFIED:	TITLE:				
REV.	DATE	By	CHANGES MADE	THE INFORMATION CONTAINED IN THIS DRAWING IS THE SOLE PROPERTY OF UNI-GRIP, INC. ANY REPRODUCTION IN PART OR AS A WHOLE WITHOUT THE WRITTEN PERMISSION OF UNI-GRIP, INC. IS PROHIBITED.	DIMENSIONS ARE IN INCHES	DU-200				
A					WEIGHT				0.054 LB/FT	
B					ASTM D1056	2A4	SIZE	DWG. NO.	REV	
C					DOCUMENT CONTROL NUMBER	ASTM D2000	A	UG-1-DU-200		
D					UG-1-EN-001-FR-(030123)	3BA711 A14 B13 C12 F17				
E						DR. BY	C. VENT	DATE	7/23/2024	SHEET 1 OF 1

P:\Engineering\Prints\Master Prints\Dual Durometer\DU-200 UG-1-DU-200

SCALE: 1:1

DR. BY C. VENT

DATE 7/23/2024

SHEET 1 OF 1