

NOTES:

- 1) 70 DUROMETER DENSE EPDM RUBBER (1.200 G/CM<sup>3</sup>)
- 2) CLOSED CELL EPDM SPONGE RUBBER (0.536 G/CM<sup>3</sup>)
- 3) 1.315" WIRE INSERT (0.028 LB/FT)
- 4) REFERENCING PART # 10676

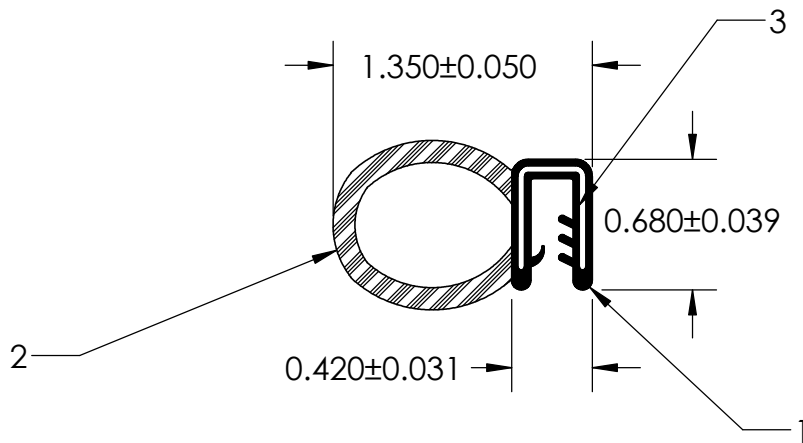
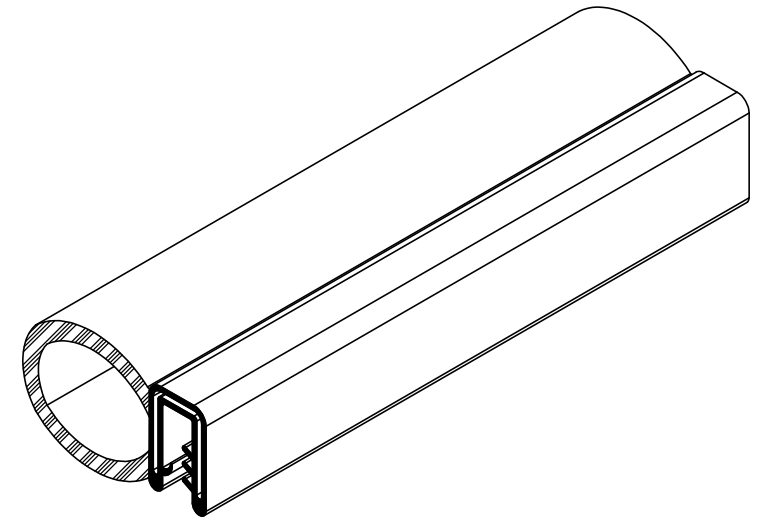

**UNI-GRIP, INC.**

9823 STATE ROUTE 53 N  
UPPER SANDUSKY, OHIO 43351

PROPRIETARY AND CONFIDENTIAL:  THE INFORMATION CONTAINED IN THIS DRAWING IS THE SOLE PROPERTY OF UNI-GRIP, INC. ANY REPRODUCTION IN PART OR AS A WHOLE WITHOUT THE WRITTEN PERMISSION OF UNI-GRIP, INC. IS PROHIBITED.	UNLESS OTHERWISE SPECIFIED:  DIMENSIONS ARE IN INCHES TOLERANCES PER ARPM CLASS 3	TITLE:  <h2 style="text-align: center;">DU-011</h2>		
	WEIGHT 0.150 LB/FT  ASTM D1056 2A2	SIZE <h1 style="text-align: center;">A</h1>	DWG. NO. UG-1-DU-1315-WR-011	REV <h1 style="text-align: center;">A</h1>
	DOCUMENT CONTROL NUMBER UG-1-EN-001-FR-(111416)	ASTM D2000 3BA711 A14 B13 C12 F17	DR. BY L. CLARK	DATE 1/26/2017
SCALE: 1:1		SHEET 1 OF 1		