

NOTES:

- 1) CLOSED CELL EPDM SPONGE RUBBER (0.510 G/CM³)
- 2) SD-487 SPRING STEEL CARRIER (0.030 LB/FT)

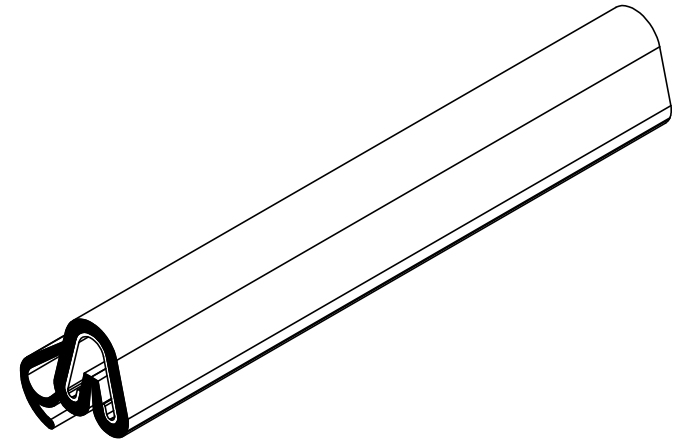
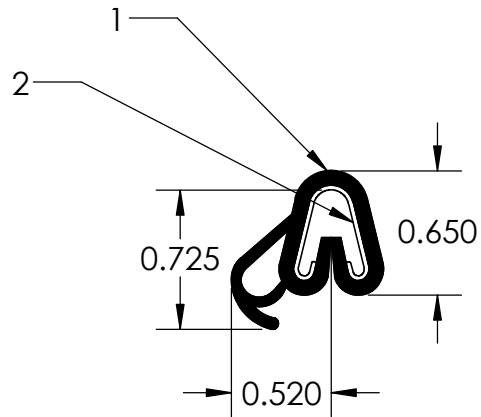

UNI-GRIP, INC.

9823 STATE ROUTE 53 N
UPPER SANDUSKY, OHIO 43351

PROPRIETARY AND CONFIDENTIAL:	UNLESS OTHERWISE SPECIFIED:
THE INFORMATION CONTAINED IN THIS DRAWING IS THE SOLE PROPERTY OF UNI-GRIP, INC. ANY REPRODUCTION IN PART OR AS A WHOLE WITHOUT THE WRITTEN PERMISSION OF UNI-GRIP, INC. IS PROHIBITED.	DIMENSIONS ARE IN INCHES TOLERANCES PER ARPM CLASS 3
	WEIGHT 0.095 LB/FT
	ASTM D1056 2A2
DOCUMENT CONTROL NUMBER UG-1-EN-001-FR-(111416)	ASTM D2000 N/A

TITLE: BL-015		
SIZE A	DWG. NO. UG-1-BL-487-ST-015	REV B

P:\Engineering\Prints\Bulb Seals\BL-015 UG-1-BL-487-ST-015

SCALE: 1:1

DR. BY L. CLARK

DATE 4/10/2017

SHEET 1 OF 1