

NOTES:

- 1) CLOSED CELL EPDM SPONGE RUBBER (0.650 G/CM³)
- 2) (2) SD-487 STEEL CARRIER (0.030 LB/FT)

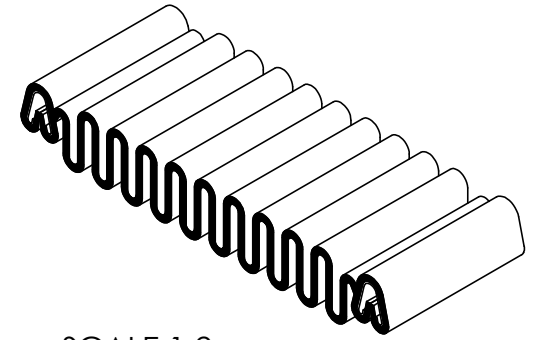

SCALE 1:2

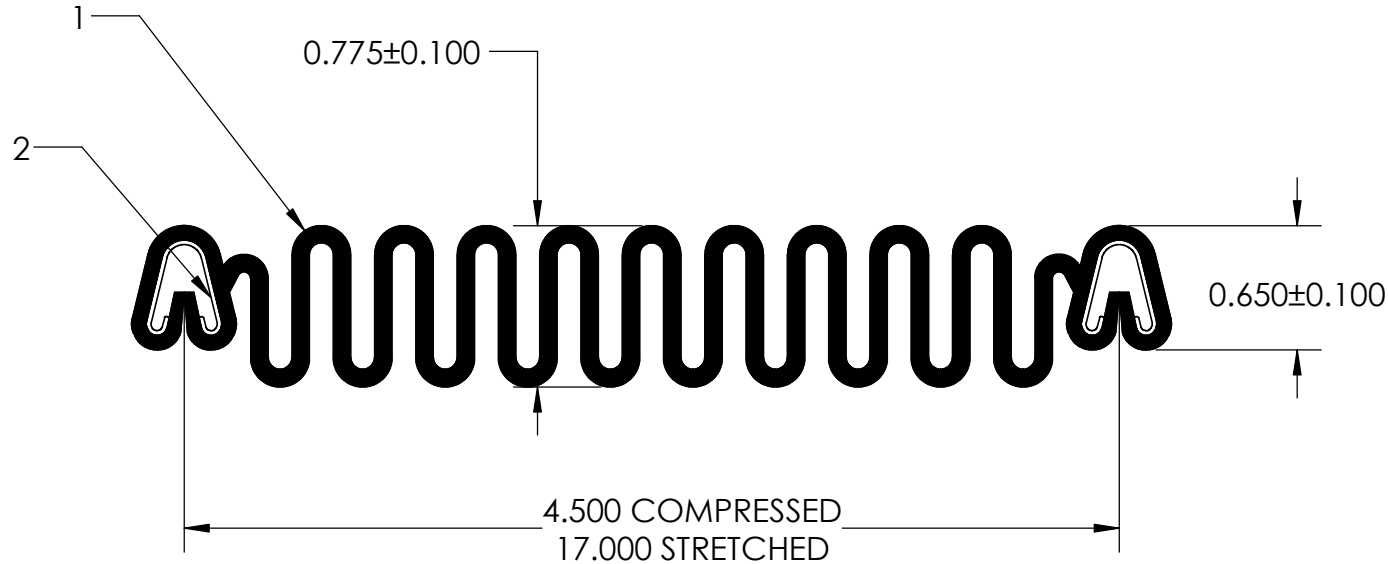

UNI-GRIP, INC.

9823 STATE ROUTE 53 N
UPPER SANDUSKY, OHIO 43351

PROPRIETARY AND CONFIDENTIAL: THE INFORMATION CONTAINED IN THIS DRAWING IS THE SOLE PROPERTY OF UNI-GRIP, INC. ANY REPRODUCTION IN PART OR AS A WHOLE WITHOUT THE WRITTEN PERMISSION OF UNI-GRIP, INC. IS PROHIBITED.	UNLESS OTHERWISE SPECIFIED:	TITLE:		
	DIMENSIONS ARE IN INCHES TOLERANCES PER ARPM CLASS 3	AC-006		
	WEIGHT 0.651 LB/FT			
DOCUMENT CONTROL NUMBER UG-1-EN-001-FR-(111416)	ASTM D1056 2A3	SIZE A	DWG. NO. UG-1-AC-487-ST-006	REV A
	ASTM D2000 N/A	DR. BY L. CLARK	DATE 9/13/2017	SHEET 1 OF 1